

**Cod. XC100GR**

### Standard and Approvals

- Switch according to IEC/EN 60947-3
- Certified UL60947-4-1A and CAN/CSA C22.2 No. 60947-4-1-07
- Suitable as Manual Motor Controller



### Technical characteristics

- Earth pole for DS50-63-80-100
- IP20 protection degree
- Rating operational current Ie: 100A (AC-21A)
- Rating thermal current Ith: 100A
- Rating insulation voltage: 690V
- Rear Mounting
- Positive opening double break contacts, silver alloy made.
- Self-extinguishing class V2

### Dimension

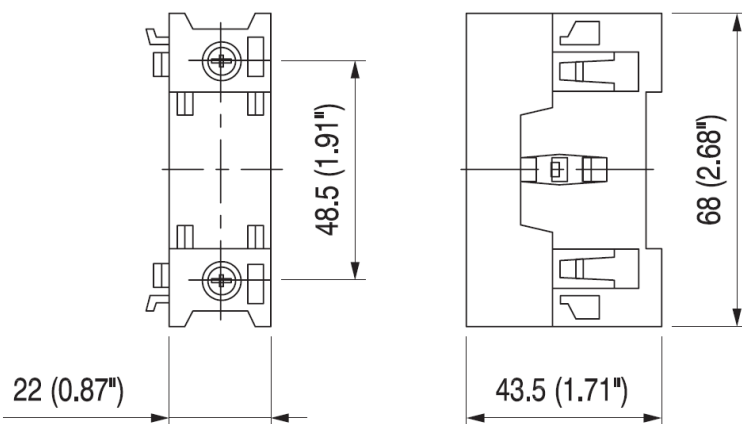

### Electrical scheme

